



## Materials

Accessory to install one luminaire to a pole. Injection aluminum support primed and powdercoat finished. Stainless steel screws.

## Installation



Cylindric  
individual

Fix the accessory to the pole and later the luminaire to the accessory.  
The anchoring system is integrated into the luminaire. The accessory is delivered disassembled.  
Instructions and screws included.  
\*Luminaire not included.

For further information go to [urbidermis.com](http://urbidermis.com)

## Finishes

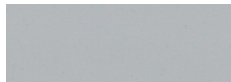

Light grey

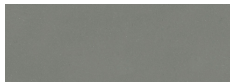

Medium grey

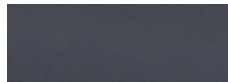

Dark grey

\*The colours shown are merely indicative and may differ from reality. (Other colours on request)

\*\*Request finishes for marine environments

## Weight kg [lb] (unpacked)

1,75 [3.9]

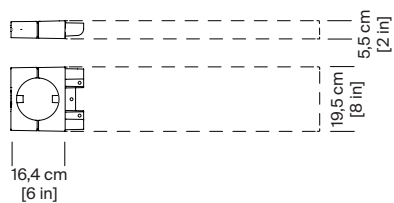

RAA01

Headquarters Parc de Belloch  
Ctra. C-251, Km 5,6  
E-08430 La Roca (Barcelona, Spain)  
+34 938 619 100

Warehouse  
Carrer del Fou. Polígono Industrial Sud  
E-08440 Cardedeu (Barcelona, Spain)  
+34 938 619 182





## Materials

Accessory to install two luminaires to a pole. Primed and powder coated injected aluminium support. Stainless steel screws.

## Installation



Cylindric  
double

Fix the accessory to the pole and subsequently the luminaires to the accessory.  
The anchoring system is integrated into the luminaire. The accessory is delivered disassembled.  
Instructions and screws included.  
\*Luminaire not included.

For further information go to [urbidermis.com](http://urbidermis.com)

## Finishes



Light grey

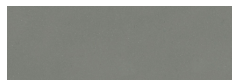

Medium grey

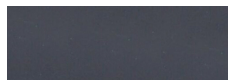

Dark grey

\*The colours shown are merely indicative and may differ from reality. (Other colours on request)

\*\*Request finishes for marine environments

## Weight kg [lb] (unpacked)

1,9 [4.2]

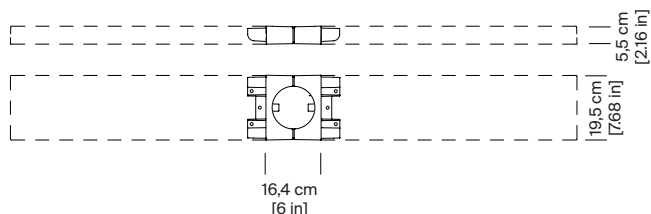

RAA02

Headquarters Parc de Belloch  
Ctra. C-251, Km 5,6  
E-08430 La Roca (Barcelona, Spain)  
+34 938 619 100

Warehouse  
Carrer del Fou. Polígono Industrial Sud  
E-08440 Cardedeu (Barcelona, Spain)  
+34 938 619 182





## Materials

Accessory to install one luminaire to a flat pole. Primed and powder coated injected aluminium support. Stainless steel screws.

## Installation



Flat individual

Fix the accessory to the pole and later the luminaire to the accessory.  
The anchoring system is integrated into the luminaire. The accessory is delivered disassembled.  
Instructions and screws included.  
\*Luminaire not included.

For further information go to [urbidermis.com](http://urbidermis.com)

## Finishes



Light grey

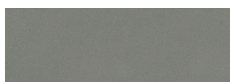

Medium grey

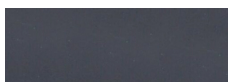

Dark grey

\*The colours shown are merely indicative and may differ from reality. (Other colours on request)

\*\*Request finishes for marine environments

## Weight kg [lb] (unpacked)

0,6 [1.3]

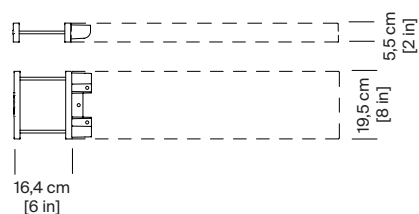

RAA03

Headquarters Parc de Belloch  
Ctra. C-251, Km 5,6  
E-08430 La Roca (Barcelona, Spain)  
+34 938 619 100

Warehouse  
Carrer del Fou. Polígono Industrial Sud  
E-08440 Cardedeu (Barcelona, Spain)  
+34 938 619 182



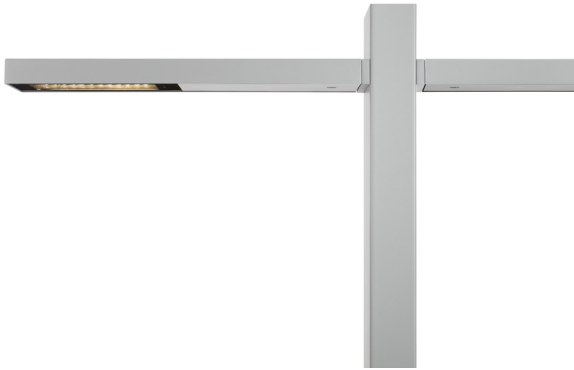

## Materials

Accessory to install two luminaires to a flat pole. Primed and powder coated injected aluminium support. Stainless steel screws.

## Installation



Flat  
double

Fix the accessory to the pole and later the luminaire to the accessory.  
The anchoring system is integrated into the luminaire. The accessory is delivered disassembled.  
Instructions and screws included.  
\*Luminaire not included.

For further information go to [urbidermis.com](http://urbidermis.com)

## Finishes

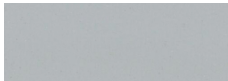

Light grey

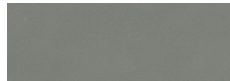

Medium grey

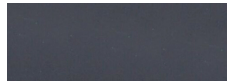

Dark grey

\*The colours shown are merely indicative and may differ from reality. (Other colours on request)

\*\*Request finishes for marine environments

## Weight kg [lb] (unpacked)

0,8 [1.8]

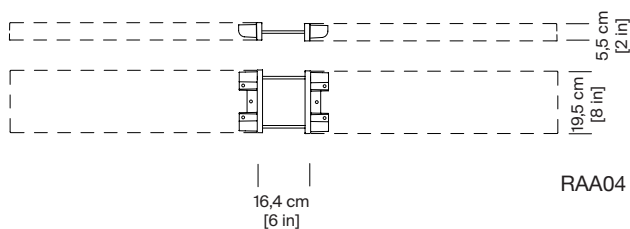

Headquarters Parc de Belloch  
Ctra. C-251, Km 5,6  
E-08430 La Roca (Barcelona, Spain)  
+34 938 619 100

Warehouse  
Carrer del Fou. Polígono Industrial Sud  
E-08440 Cardedeu (Barcelona, Spain)  
+34 938 619 182





## Materials

Accessory to install one luminaire to a Ø 50/60/62 mm pole tenon. Primed and powder coated injected aluminium support. Stainless steel screws.

## Installation



Retrofit

Fix the accessory to the pole tenon and subsequently the luminaire to the accessory. The anchoring system is integrated into the luminaire. Once installed, it allows adjusting the inclination of the luminaire from  $-5^{\circ}$  to  $+90^{\circ}$  degrees, adapting the orientation of the luminaire according to the pole. The accessory is delivered disassembled. Instructions and screws included. \*Luminaire not included.

For further information go to [urbidermis.com](http://urbidermis.com)

## Finishes

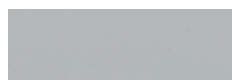

Light grey

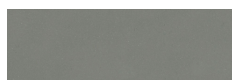

Medium grey

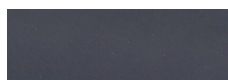

Dark grey

\*The colours shown are merely indicative and may differ from reality. (Other colours on request)

\*\*Request finishes for marine environments

## Weight kg [lb] (unpacked)

1 [2.2]

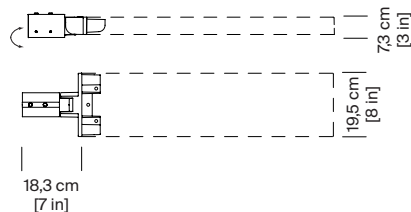

RAA06

Headquarters Parc de Belloch  
Ctra. C-251, Km 5,6  
E-08430 La Roca (Barcelona, Spain)  
+34 938 619 100

Warehouse  
Carrer del Fou. Polígono Industrial Sud  
E-08440 Cardedeu (Barcelona, Spain)  
+34 938 619 182



# Rama Pole

Gonzalo Milá. 2000

Urbidermis

## Composition examples

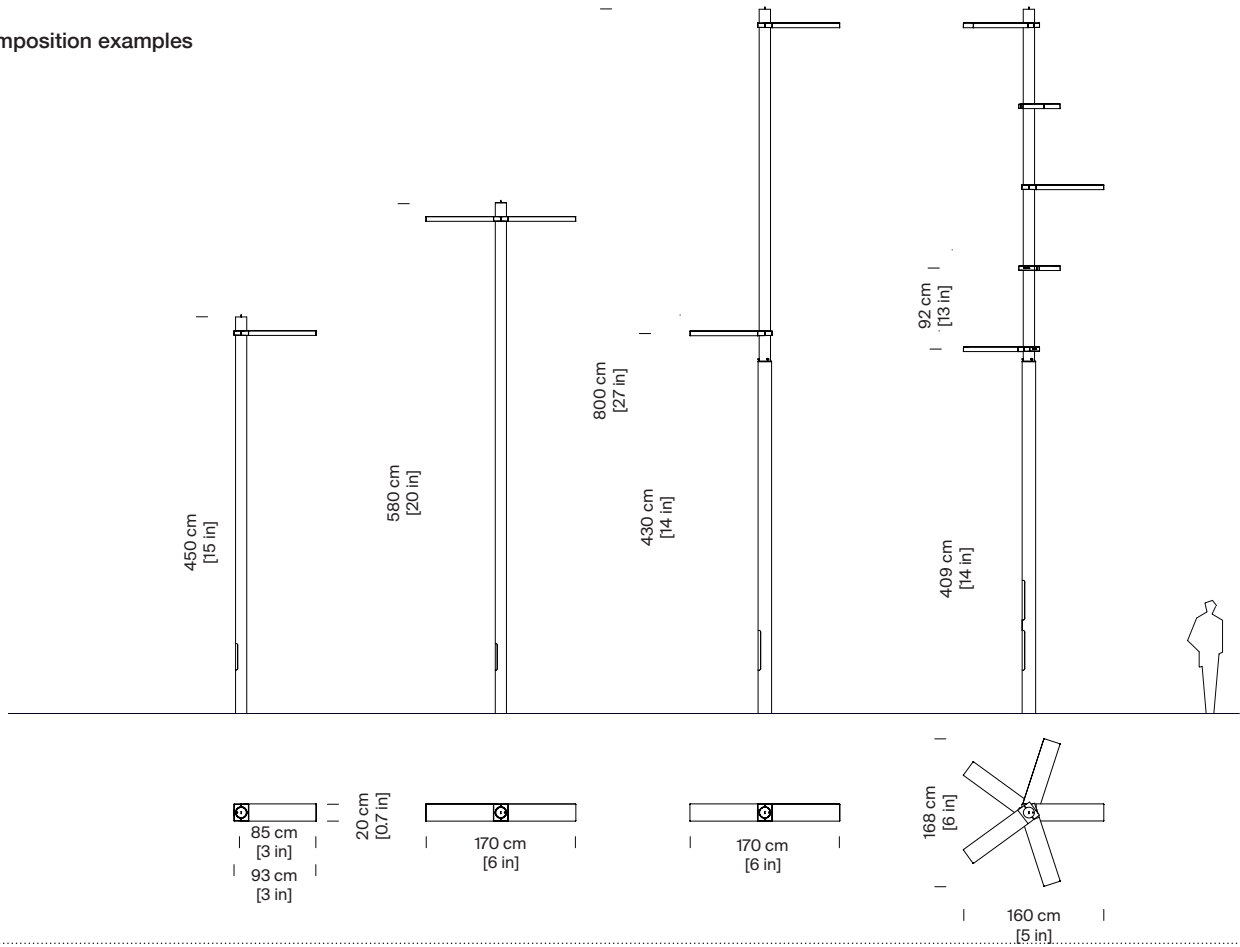

## Materials

Cylindrical tube S-275 JR Class 1 steel poles of one or two sections depending on height, hot-dip galvanised and primed painted steel, or two segments poles with the higher one made of AISI 304 stainless steel and the lower one made of hot-dip galvanised and primed painted steel. Steel bolts (275) zinc-plated.

## Installation

The pole is installed using a concrete cube, with a groove for the wiring and anchor bolts, 20 cm [8 in] below the pavement level. Installation template and pole anchor bolts included.

For more information go to [urbidermis.com](http://urbidermis.com)

### Distance between bolts

Poles: 4,7 / 6,0 [14 / 20 ft]

Base: 210 x 210 mm [8 x 8 in]

Poles: 8,2 / 9,2 [27 / 30 ft]

Base: 300 x 300 mm [12 x 12 in]

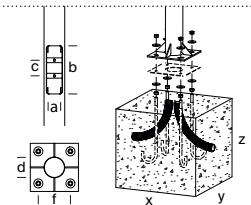

## Standards

305/2011/EU Regulation, UNE-EN 40, UNE-EN-ISO 1461.

## Finishes



Light grey

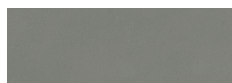

Medium grey

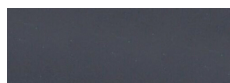

Dark grey

\*The colours shown are merely indicative and may differ from reality. (Other colours on request)

\*\*Request finishes for marine environments.

Reference	Total height (m) [ft]	Visible height (m) [ft]	Outer sizes (mm) [in] (D)	Thickness (mm) [in]	Base plate (mm) [in]	Spacing between bolts (mm) [in]	Bolts (x4) (F)	N° Doors	Door (A/B/C) (mm) [in]	Foundation (X/Y/Z) (mm) [in]	N° Luminaires accepted								
RAF11P	4,7 [15]	4,4 [14]	Ø 127 [Ø 5]	3	300x300x10 [12x12x0.39]	210x210 [8x8]	M18x500	1	83/300/97 [3/12/4]	650x650x600 [26x26x24]	1/2								
RAF21P	6 [20]	5,8 [19]										Ø 127 [Ø 5]	300x300x10 [12x12x0.39]	210x210 [8x8]	M18x500	1	83/300/97 [3/12/4]	650x650x600 [26x26x24]	2
RAF31P																			
RAF51P	8,2 [27]	8,0 [26]	Ø 127 [Ø 5]		400x400x10 [16x16x0.39]	300x300 [12x12]			M18x500	1	102/450/118 and 182 [4/18/5 and 7]	900x900x700 [35x35x28]	1/2						
RAF54																			
RAF61P																			
RAF62P																			
RAF64P																			
RAF65P																			
RAF71P																			
RAF74P	9,2 [30]	9,0 [30]	Ø 152 [Ø 6]	400x400x10 [16x16x0.39]	300x300 [12x12]	M18x500	2	102/450/118 and 182 [4/18/5 and 7]	900x900x700 [35x35x28]	2									
RAF81P																			
RAF83P																			
RAF85P																			
RAF86P	9,2 [30]	9,0 [30]	Ø 152 [Ø 6]	400x400x10 [16x16x0.39]	300x300 [12x12]	M18x500	2	102/450/118 and 182 [4/18/5 and 7]	900x900x700 [35x35x28]	5									
RAF86P																			

\*Recommendations: for calculation in ground type II (according to UNE-40) and wind speed of 29 m/s, with soil formed by loose or wet dirt or sand of medium compactness ( $E_0 = 4800 \text{ KN/m}^2$ ), with HM-20 concrete. Non-binding information. We advise to carry out checks for each situation.

Headquarters Parc de Belloch  
Ctra. C-251, Km 5,6  
E-08430 La Roca (Barcelona, Spain)  
+34 938 619 100

Warehouse  
Carrer del Fou. Polígono Industrial Sud  
E-08440 Cardedeu (Barcelona, Spain)  
+34 938 619 182

